

onyx

# Orbit Electric

LED ELECTRIC FIRE

Vaulted Ceiling Installation Kit



**Instructions for Installation**  
**For use in UK & Republic of Ireland**

## CONTENTS

### ORBIT - LED Electric Fire - Vaulted Ceiling Installation Kit

|              |
|--------------|
| <b>ORBIT</b> |
| 628-020      |

|                                       |          |
|---------------------------------------|----------|
| <b>Welcome Note.....</b>              | <b>3</b> |
| <b>Installation Instructions.....</b> | <b>4</b> |
| Dimensions.....                       | 5        |
| Technical Specification.....          | 6        |
| Warning.....                          | 7        |
| Installation.....                     | 8        |
| Product Material Information.....     | 15       |



CONSUMER SUPPORT VIDEO:  
[www.stovax.tv/support/orbit](http://www.stovax.tv/support/orbit)





# Service that goes above and beyond

Congratulations on becoming a new owner of an Onyx stove or fire – welcome to the family.

When you own an Onyx product, you can expect the very best in British stove and fire design and engineering, bringing exceptional heating performance to your home along with character and individuality.

We take great care to ensure that our stoves are designed, tested and manufactured to the highest possible quality standards, and pride ourselves on offering the same exemplary after-sales service that goes above and beyond, assuring you years of enjoyment from your Onyx purchase.



## INSTALLATION

### GENERAL

#### TOOLS REQUIRED

A Screwdriver, Spanners, 6mm Allen Key, Spirit Level, Saw and Drill will be needed.

#### UNPACKING THE FIREPLACE

**WARNING! DO NOT use this appliance if any part has been exposed to water.**

Immediately call a qualified service technician to inspect and to replace any part of the electrical system if necessary.

Open the packaging carefully and remove the polystyrene. Remove and discard the plastic bag. Keep plastic wrapping away from children. Be responsible when handling the packing materials. Check all parts and accessories are removed before disposing of any packaging. If necessary keep the original packaging for future transport and/or storage.

Test the appliance before installation.

### FITTING THE APPLIANCE

#### LOCATING THE ORBIT

Your new Orbit may be installed virtually anywhere in your home. However, when choosing a location ensure that the general instructions are followed.

For best results, install out of direct sunlight.

**CAUTION: THIS APPLIANCE IS HEAVY. The Orbit is designed to be installed as a suspended application and fixed onto a suitably robust load bearing item such as a ceiling joist or beam. Identifying a suitable load bearing item is not the responsibility of Onyx. It is your responsibility to consult with an engineer or architect in conjunction with a suitably competent electrician to assess the strength capacity of the prospective load bearing item before installing the Orbit.**

Ensure there is enough clearance when hanging the appliance to maintain physical clearances and clearances to combustibles.

This product must be wired into a dedicated mains power supply. The installation must be installed in accordance with all local and national regulations to ensure that all electrical and structural considerations are adhered to.

When the fire has been installed, the power supply must be accessible in order to isolate during servicing and maintenance if required.

If the power cord is damaged, it must be repaired by the manufacturer, its authorised service centre or professional person.

Ensure that curtains and furniture are not positioned close to the chosen position, as this would create a potential fire hazard or block the heater outlet ducts.

**WARNING! KEEP ALL COMBUSTIBLE MATERIALS AT LEAST 1M FROM THE FRONT OF THE APPLIANCE AND DO NOT PLACE ANY ITEM ON OR LEAN ANY ITEM AGAINST THE APPLIANCE AT ANY TIME.**

### SERVICING REQUIREMENTS



**DURING SERVICING OF THIS APPLIANCE IT MAY BE NECESSARY TO CUT CABLE TIES IN ORDER TO ACCESS AND REMOVE SOME OF THE PARTS. THESE MUST BE REPLACED WHEN REASSEMBLING THE APPLIANCE.**

**THIS APPLIANCE MUST ONLY BE SERVICED BY A SUITABLY QUALIFIED PERSON. BEFORE UNDERTAKING ANY WORK ON THE APPLIANCE: SWITCH OFF THE APPLIANCE AND ISOLATE THE POWER SUPPLY ENSURING THERE IS NO POWER TO THE APPLIANCE.**

Wait for at least 10 minutes until the appliance has cooled down.

#### Remote Handset Battery Replacement

Replace with 2 AAA batteries. Make sure the batteries are installed correctly in the remote control.



**NOTE: The remote control has a Battery Status indicator (top right corner), after an extended period of displaying empty the LED screen will cease to function despite the handset still being able to send commands. Replace the batteries to restore display.**

#### Maintenance of Motors

The motor used on the flame effect is pre-lubricated for extended bearing life and requires no further lubrication. However, periodic cleaning/vacuuming of the heater unit is recommended.

#### Resetting the Thermal Cutout Switch

The appliance is fitted with an Electronic Safety Control (E.S.). This is a safety device which switches off the fire if the appliance overheats for any reason e.g. when covered.

If the heater stops operating whilst the flame effect continues normally, this indicates that the E.S. Control is in operation. The E.S. Control can only be re-set after the appliance has cooled down.

To re-set the E.S:

Switch off the appliance (Manual On/Off switch) and leave for approximately 120 minutes.

Remove any obstruction to the fan heater outlet or other internal parts.

Switch on appliance and the E.S. Control will re-set. Ensure that the appliance is functioning correctly. If the E.S. Control operates again, the appliance should be checked by a competent Electrician.

## DIMENSIONS

ORBIT

628-020

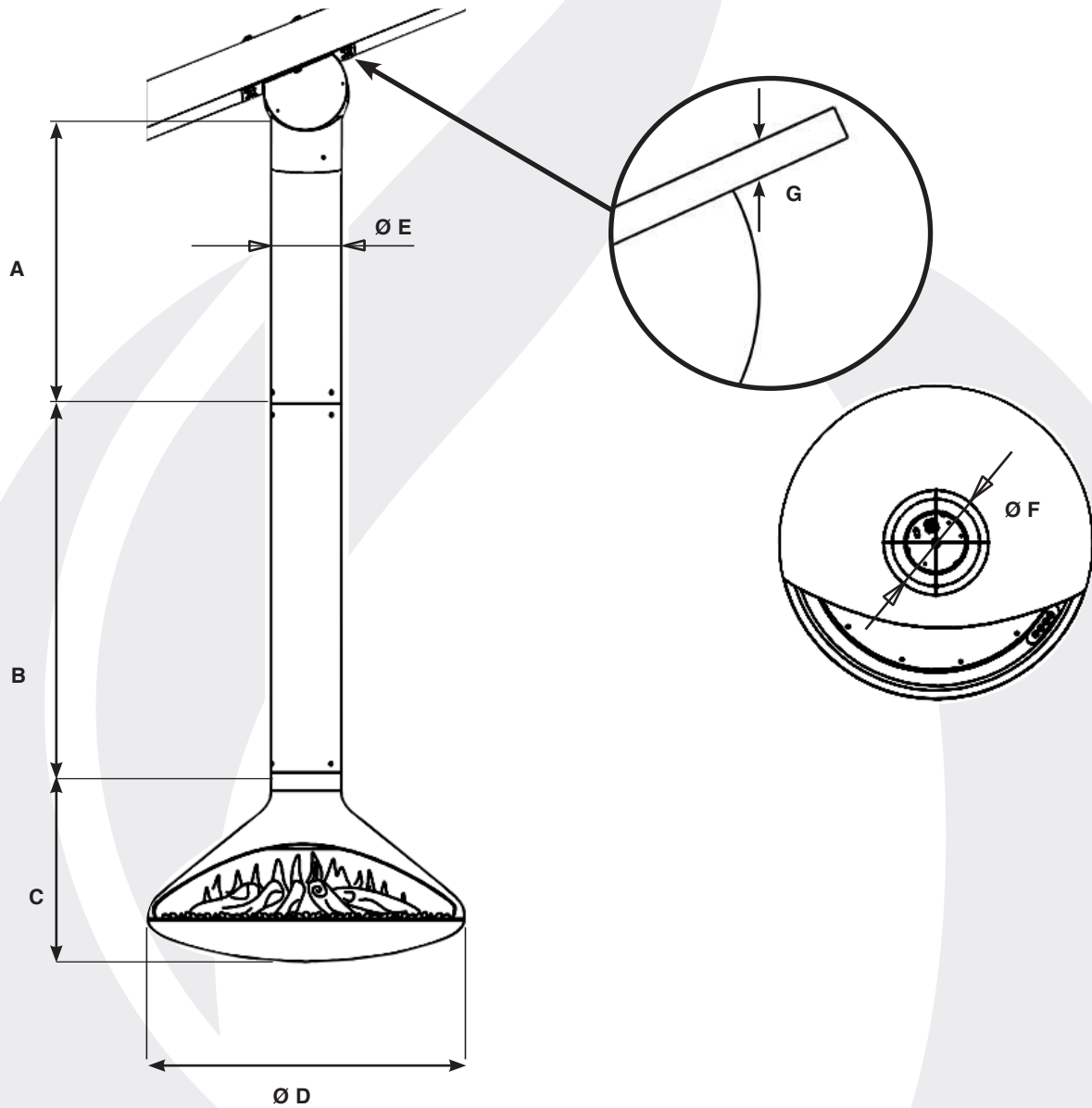

| MODEL      | A   | B    | C   | D   | E   | F   | G |
|------------|-----|------|-----|-----|-----|-----|---|
| Orbit (mm) | 800 | 1600 | 537 | 900 | 200 | 200 | 5 |

## CLEARANCES

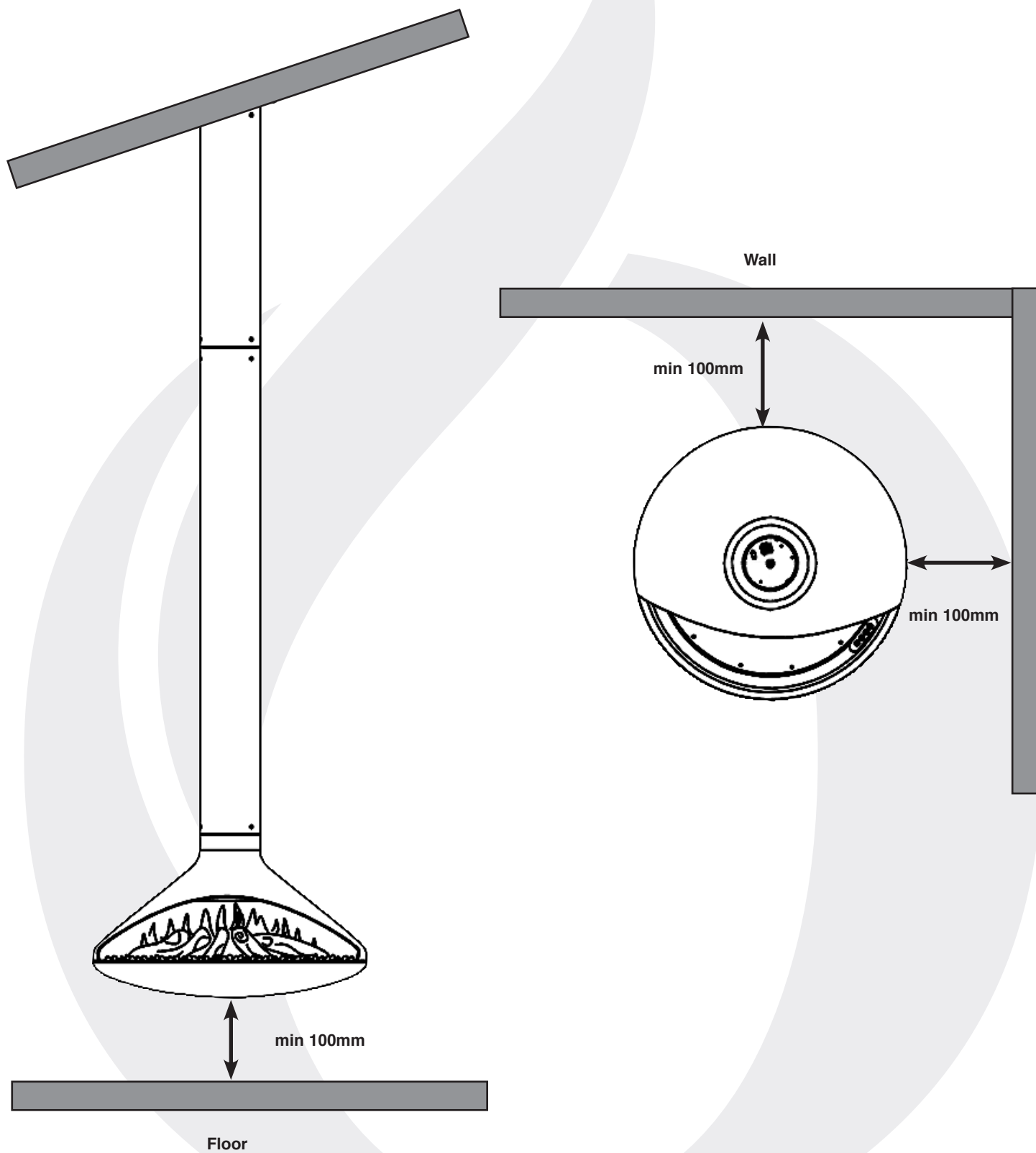

## WARNING

**WARNING! The Orbit is hot while in operation. Keep children under the age of 12, pets, the elderly and infirm away and use a suitable fireguard to protect them and others from direct contact. Contact may cause skin burns.**

Do not put any item on, near or against the appliance. Do not let children play or undertake any recreational activity on or near this appliance.

Only install after identifying a suitable load bearing item, such as a ceiling joist or beam. Identifying a suitable load bearing item is NOT the responsibility of Onyx. It is your responsibility to consult with an engineer or architect in conjunction with a suitably competent electrician to assess the strength capacity of the prospective load bearing item.

Do not try to adjust this appliance after installation.

Onyx is not responsible for the installation, maintenance or usage of this appliance.

Any property damage or personal injury caused by the installation, failure to maintain or misuse of this appliance is not the responsibility of Onyx. Please ensure you discuss any necessary precautions or protection with your chosen engineer, architect, electrician or installer **BEFORE** commencing installation.

**DAMAGE CAUSED FROM FAILURE TO COMPLY WITH THIS WARNING AND THE INSTALLATION INSTRUCTIONS IN THESE INSTRUCTIONS FOR USE AND INSTALLATION IS NOT COVERED BY ONYX.**

## INSTALLATION

**i**

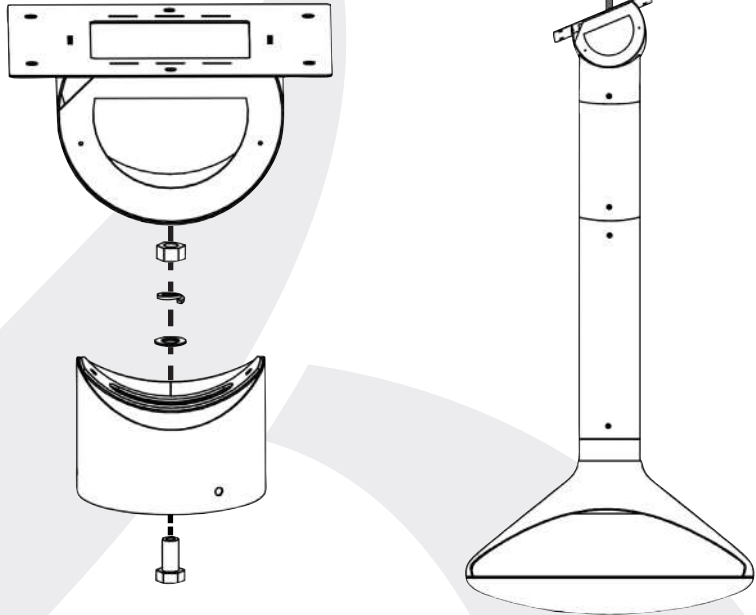

**1**

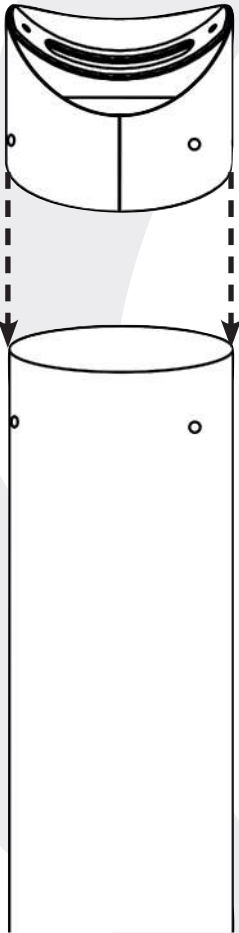

**2**

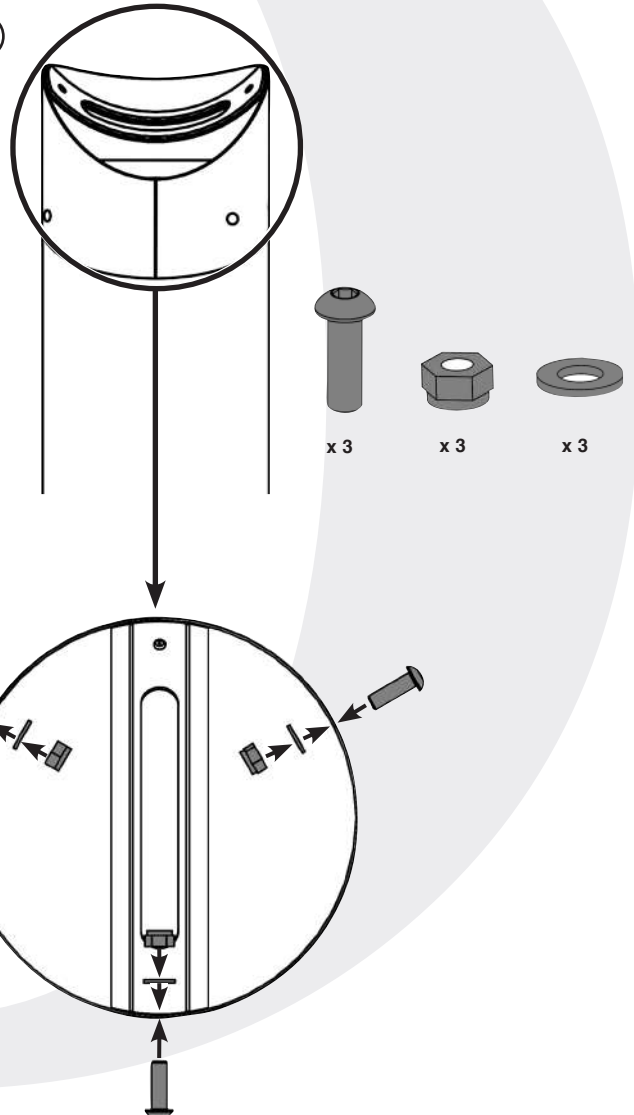



## INSTALLATION

3

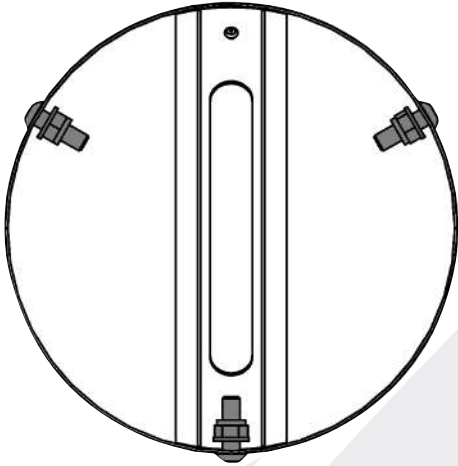

5

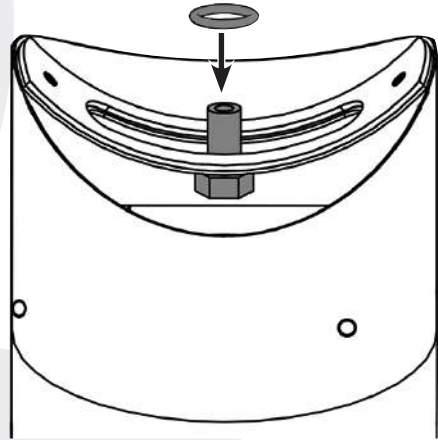

4



6

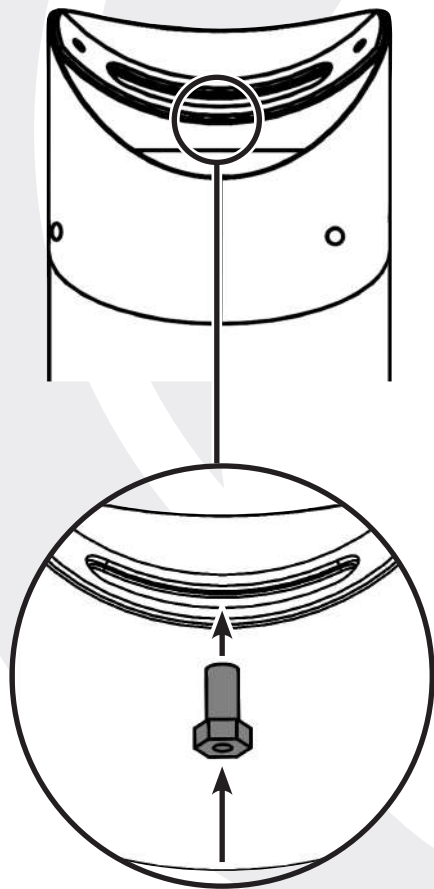
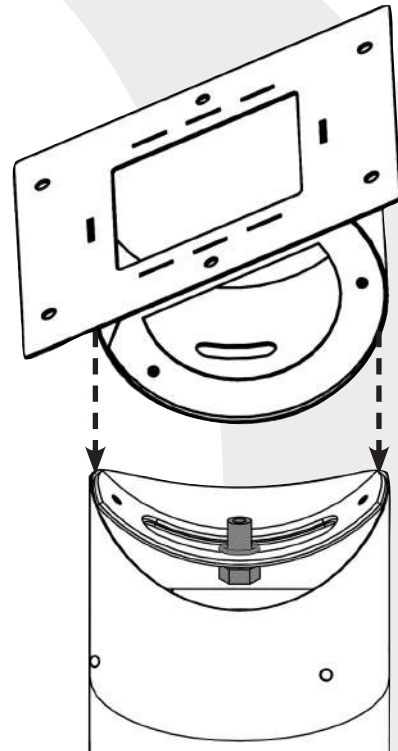

7

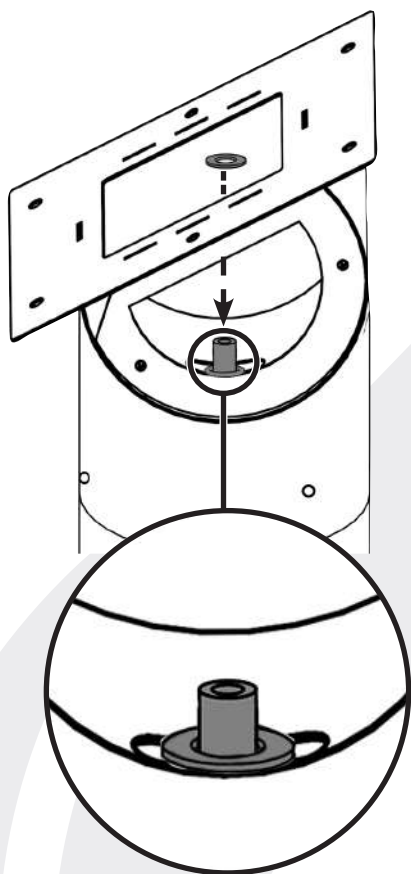

9

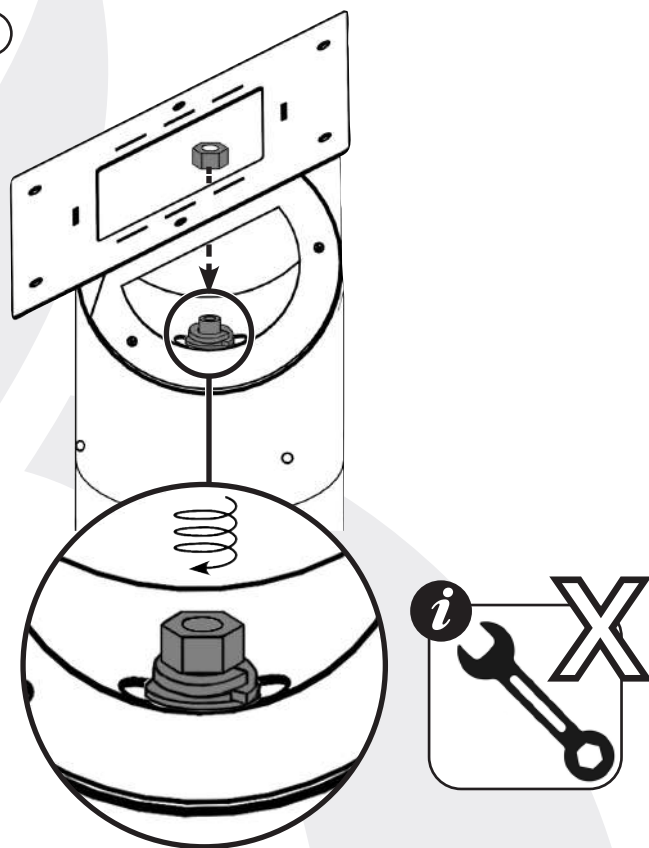

8

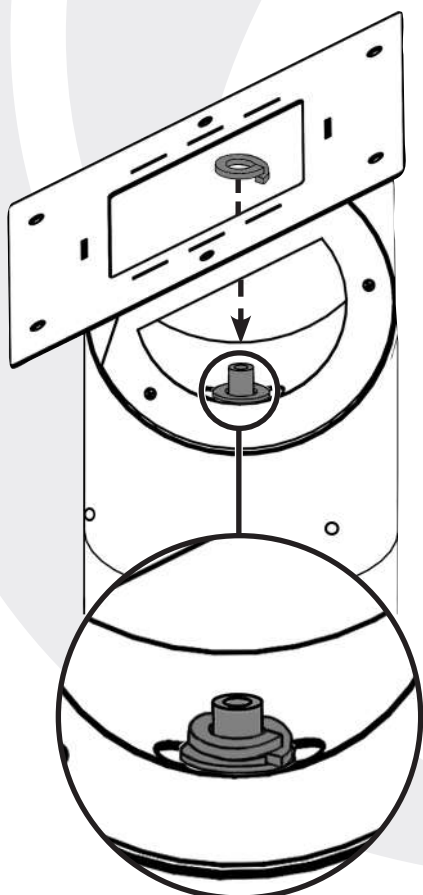

10

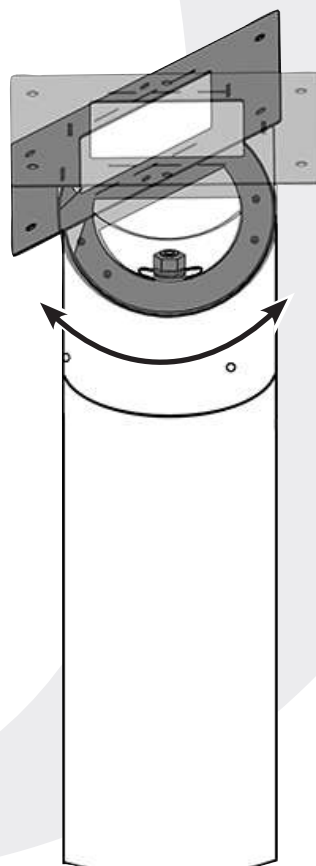

## INSTALLATION

### JOIST ATTACHMENT

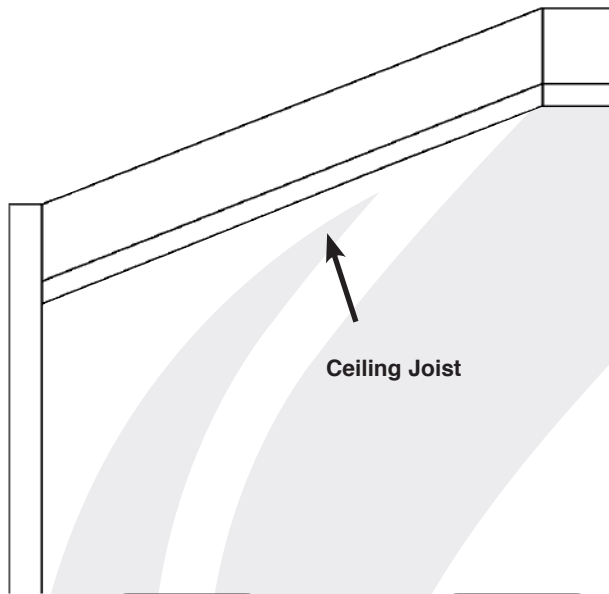
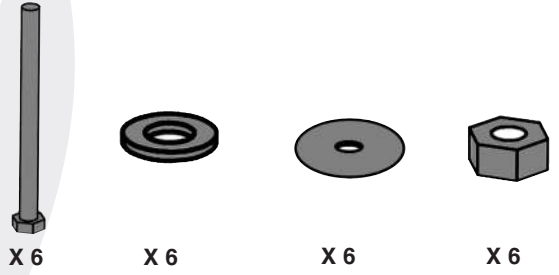

2

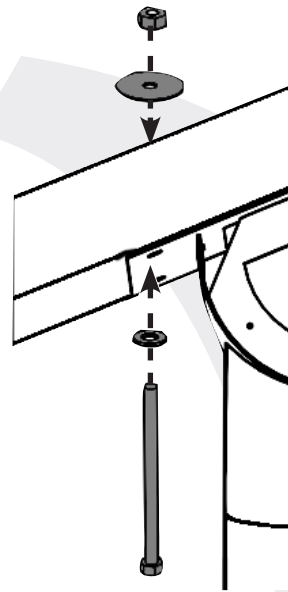

*i* Repeat  
x 6

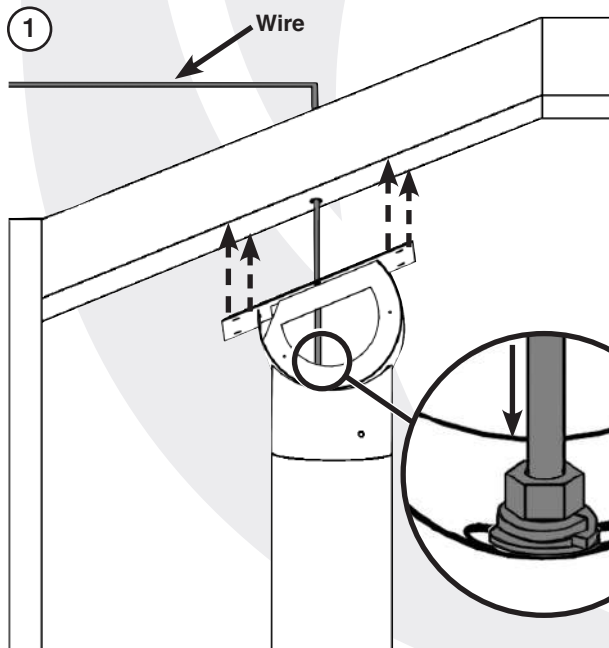

1

3

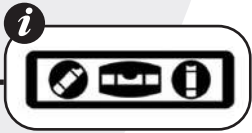
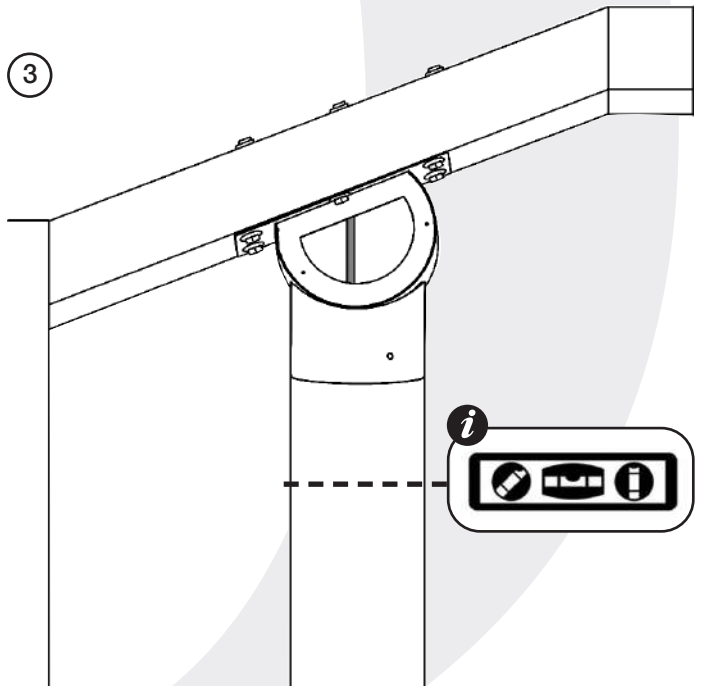

## INSTALLATION

4

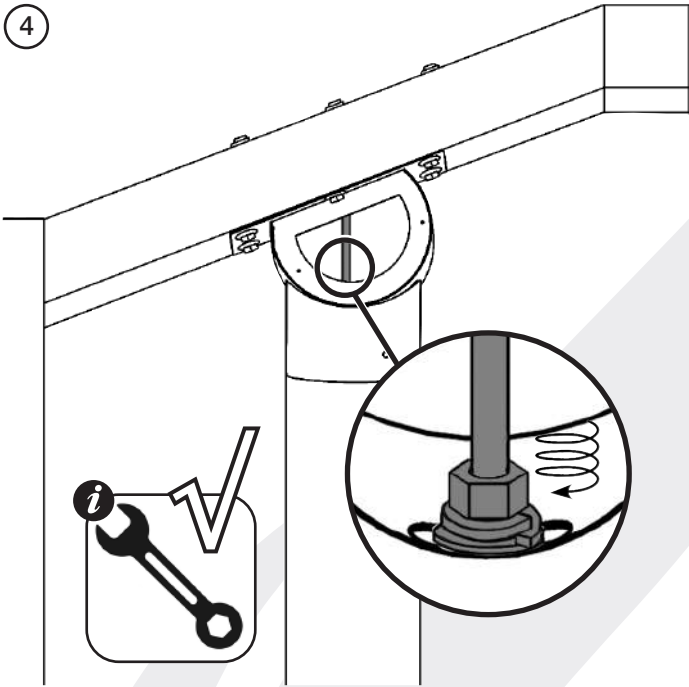

### FLUE ATTACHMENT

1

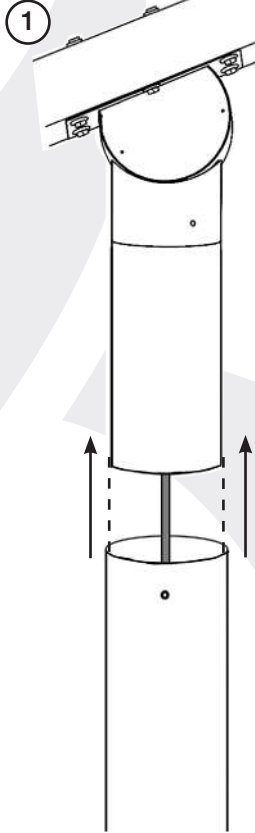

5

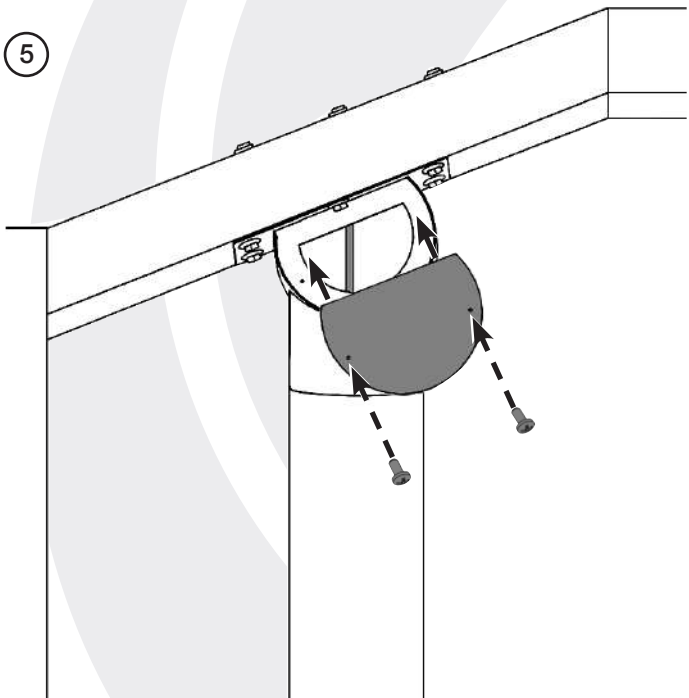

2

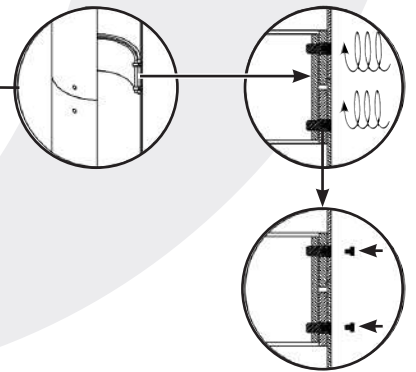
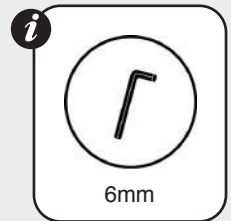
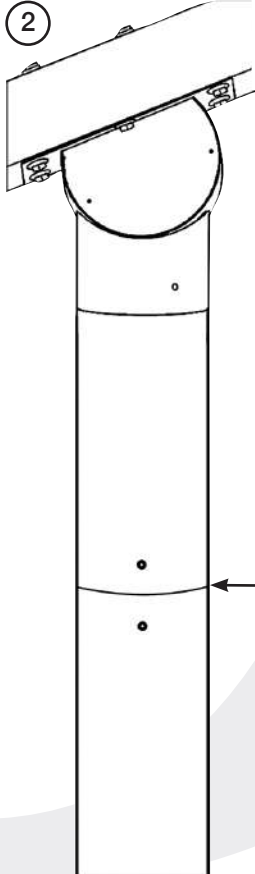

## INSTALLATION

### FIRE ATTACHMENT



This appliance is extremely heavy and requires fixing to a secure medium.

65kg



①

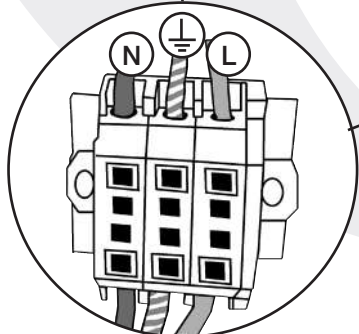
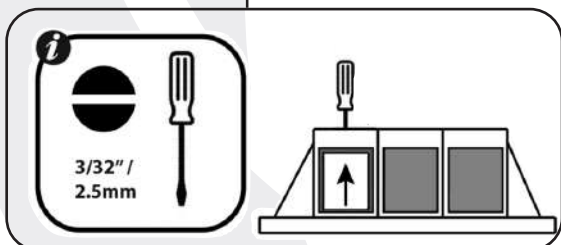
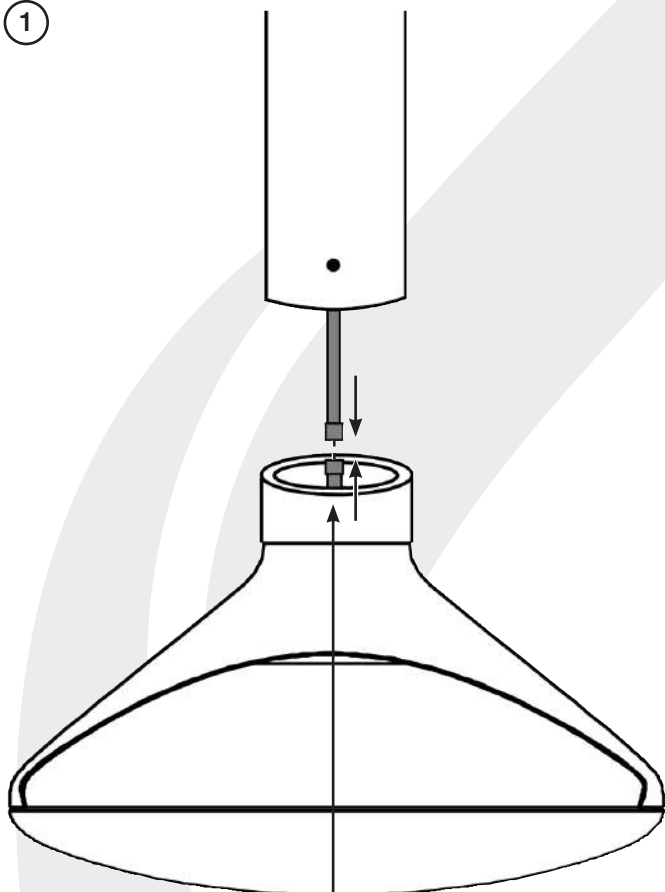

②

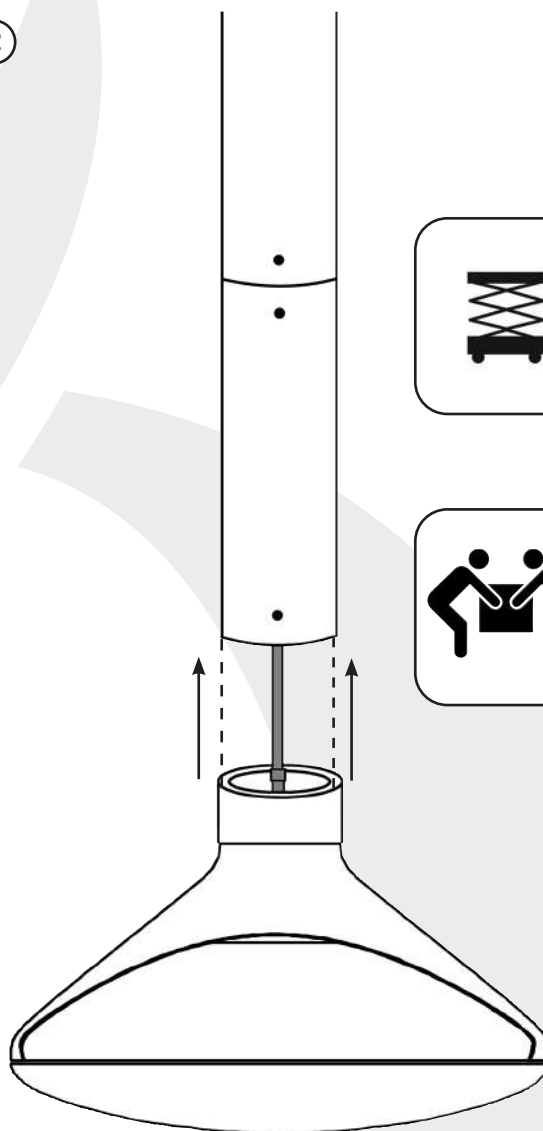

min. 1.0mm<sup>2</sup> CSA / 16 AWG.

220-240VAC 50Hz 10A

3

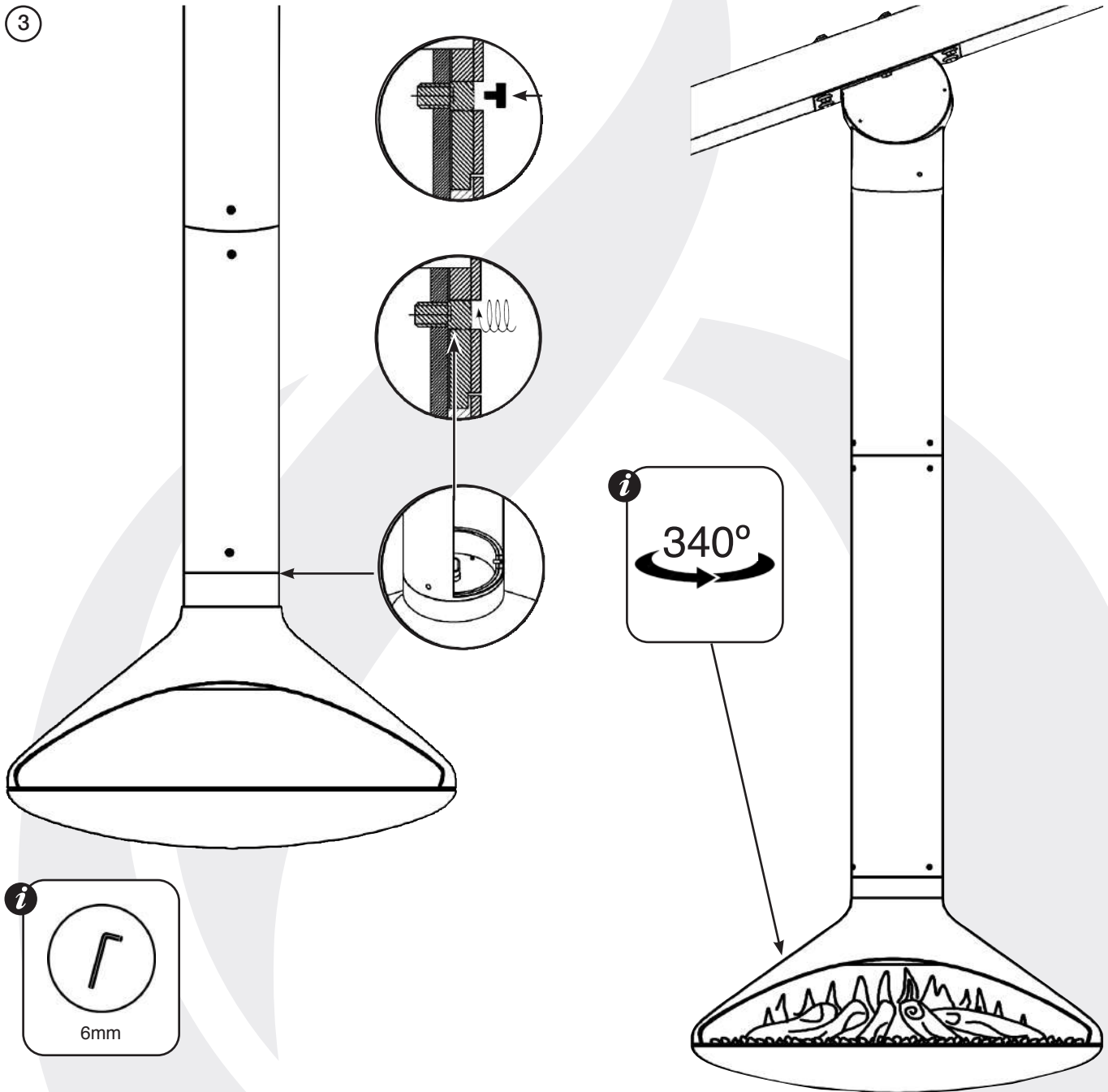

## PRODUCT MATERIAL INFORMATION

When the waste bin symbol with a cross is found on a product, it means that this product is subject to the European Directive 2012/19 / EU (implemented by the national legislation with the legislative decree of March 14, 2014, n.49).

In accordance with European Directive 2012/19/ EU, waste electrical and electronic equipment (WEEE) must not be disposed of with household or unsorted municipal waste.

At the end of its useful life please take this product to an appropriate recycling centre, collection point or utilise a distributor take-back service. Failure to do so may result in negative effects on the environment and/or human health as a result of the possible presence of hazardous substances in electrical and electronic equipment and of the mishandling of such equipment.

You can find your nearest recycling centre by contacting your local authority, for UK customers using the bank locator at [www.recycle-more.co.uk](http://www.recycle-more.co.uk) or for customers in the Republic of Ireland at [www.weeeireland.ie](http://www.weeeireland.ie). Take-back services can be discussed with your authorised dealer.



**FOR ENQUIRIES IN THE U.K (EXCLUDING NI):**

**Onyx Ltd, Osprey Road, Sowton Industrial Estate, Exeter, Devon, England EX2 7JG**

**Tel: (01392) 261900 E-mail: [info@onyxfires.com](mailto:info@onyxfires.com)**

**FOR ENQUIRIES IN EUROPE (INCLUDING NI):**

**Stovax Heating Group (NI) Ltd (Comp reg NI675194), 40 Linenhall Street, Belfast, BT2 8BA**

**DX 400 NR Belfast Tel: +44 (0)1392 261990 E-mail: [northernireland@onyxfires.com](mailto:northernireland@onyxfires.com)**

**onyx**



PR3190